

move/adjust size windows to accomodate rangehood

rangehood is 1200 wide

Smart Glass SP10 to all windows & doors excluding obscure bathrooms & ensuite windows

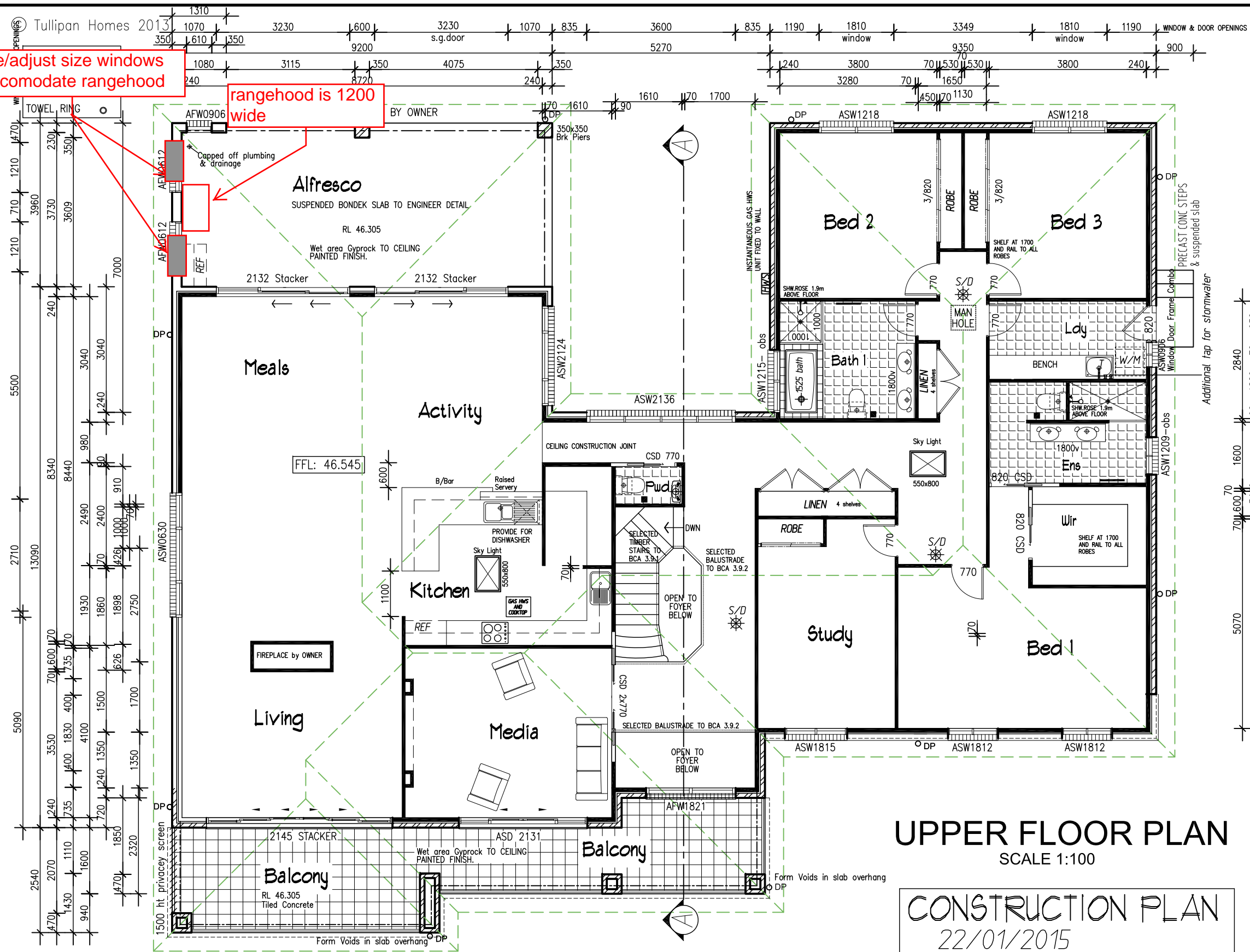

UPPER FLOOR PLAN
SCALE 1:100

CONSTRUCTION PLAN
22/01/2015

- NOTE:**
CONSTRUCTION FOR BUSHFIRE ATTACK LEVEL 29 (BAL-29 & BAL-19).
- MESH GAURDS TO WEEP HOLES & VENTS
 - Aluminium Mesh FLYSCREENS
 - METAL WEATHER STRIPS TO EXTERNAL DOORS.
 - SOLID CORE EXTERNAL DOORS - Toughened glass.
 - MERBAU Hardwood Door Jambes to hinged External doors.
 - BAL29 Metal mesh screen doors to all hinged External Doors - By Owner.
 - Provide Ember Seals to the garage door.
 - MEDIUM DUTY SARKING - Ridge caps sealed to AS3959.
 - Toughend glass must be included to all windows + built to Bal 19/29 regs.
 - Supply & installation of a mesh &/or mineral wool protection to all Ridges / Hips / Valleys & Fascias in accordance with BAL-29.
 - Metal fascia to be fixed at 300mm c/c - provide additional trimmers

plan prepared by
BUILDTECH
DESIGN & DEVELOPMENT
 ACCREDITED BUILDING DESIGNERS ABN 54 539 725 979
 Suite 18 - No.1 RELIANCE DRIVE,
 TUGGERAH N.S.W.2259
 ph.4351 8988
 fax.4353 8655
 email:buildtech@cci.net.au

 Membership No. 930099

TULLIPAN HOMES PTY LTD
 Lic. No. 131446C
 PH 02 4353 8644 Suite 18, 1 Reliance Dr
 FAX 02 4353 8655 Tuggerah Business Park
 www.tullipanhomes.com.au Tuggerah NSW 2259
 www.splitlevelhomes.com.au PO Box 5148
 CHITTAWAY BAY NSW 2261

CLIENT **J. & C. MANTILLA**
 JOB **PROPOSED RESIDENCE**
 LOCATION **Lot 6 PADDOCK CLOSE ELERMORE VALE**

- BUILDER TO CHECK ALL DETAILS AND DIMENSIONS PRIOR TO CONSTRUCTION.
 - FIGURED DIMENSIONS TAKE PREFERENCE OVER SCALE.

SHEET **3 of 11** DATE **26.08.2014** DWG No. **6269-WD3**